

TIPPECANOE COUNTY INDIANA

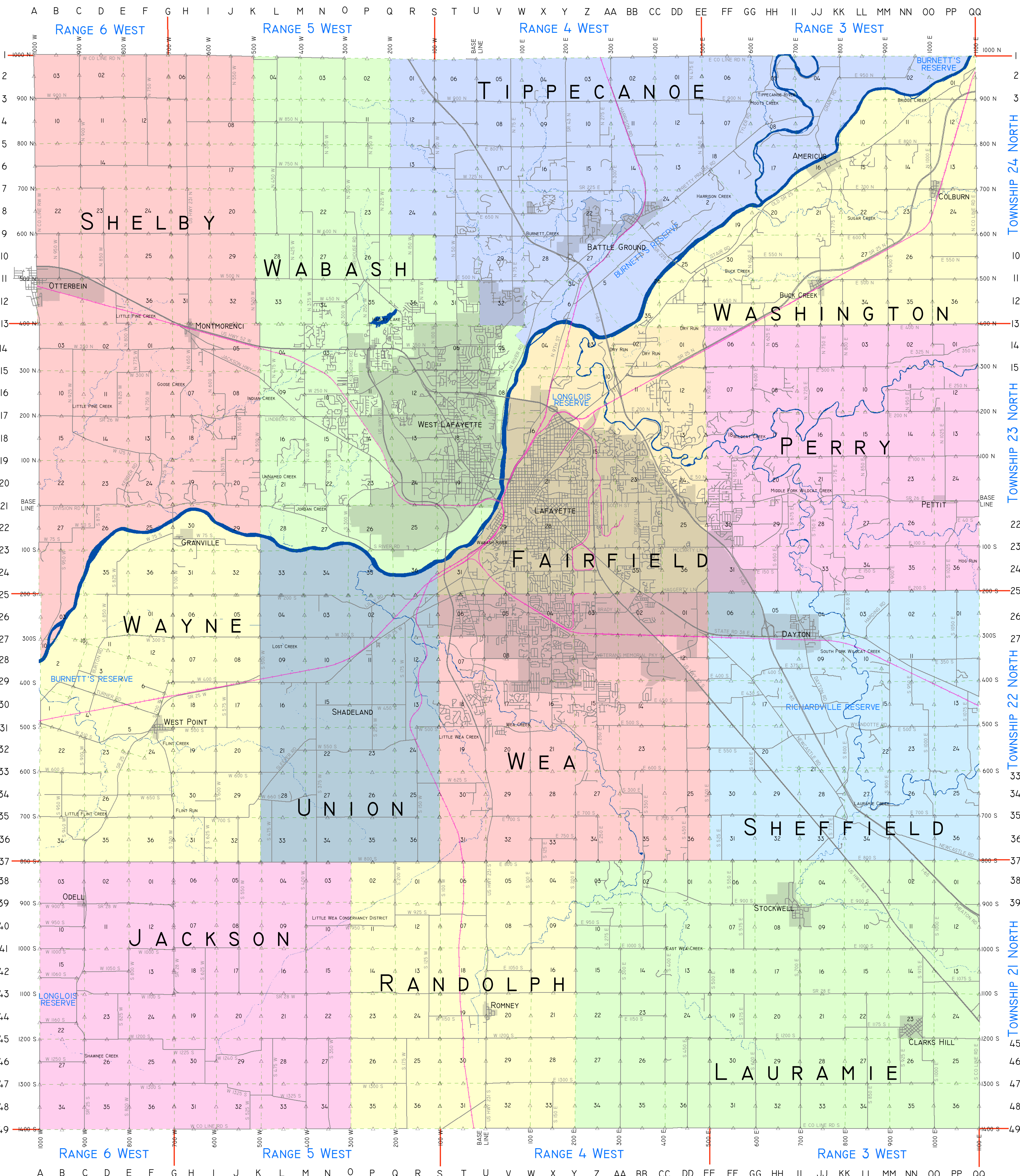

DATE UPDATED: MARCH 17, 2016

THE BOARD OF COMMISSIONERS OF TIPPECANOE COUNTY, STATE OF INDIANA, DISCLAIM ANY RESPONSIBILITY FOR THE ACCURACY OR CORRECTNESS OF THE DATA, EVEN THOUGH THE DATA HAS BEEN TESTED FOR ACCURACY AND IS BEING USED FOR VARIOUS GEOGRAPHIC INFORMATION SYSTEM (GIS) ACTIVITIES. THE FOREGOING WARRANTY IS EXCLUSIVE AND IN LIEU OF ALL OTHER WARRANTIES OR MERCHANTABILITY. FITNESS FOR PARTICULAR PURPOSE AND/OR ANY OTHER TYPE WHETHER EXPRESSED OR IMPLIED. IN NO EVENT SHALL THE TIPPECANOE COUNTY COMMISSIONERS OR TIPPECANOE COUNTY BECOME LIABLE TO USERS OF THE DATA, OR ANY OTHER PARTY, FOR ANY LOSS OR DAMAGES, CONSEQUENTIAL OR OTHERWISE, INCLUDING BUT NOT LIMITED TO TIME, MONEY, OR GOODWILL, ARISING FROM THE USE, OPERATION OR MODIFICATION OF THE DATA. IN USING THE DATA, USERS FURTHER AGREE TO INDEMNIFY, DEFEND, AND HOLD HARMLESS THE TIPPECANOE COUNTY COMMISSIONERS AND TIPPECANOE COUNTY FOR ANY AND ALL LIABILITY OF ANY NATURE ARISING OUT OF OR RESULTING FROM THE LACK OF ACCURACY OR CORRECTNESS OF THE DATA, OR THE USE OF THE DATA.

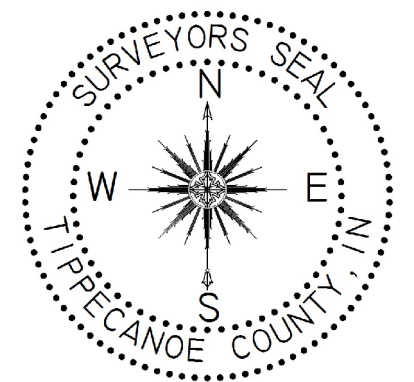

TIPPECANOE COUNTY SURVEYOR'S OFFICE
20 N 3RD STREET, LAFAYETTE, IN 47901
(765) 423-9228

- SECTION CORNER
- SURVEY SECTION LINES
- SURVEY TOWNSHIP & RANGE LINES
- ROADS
- RAILROAD

